

TSUBAKI PLASTIC TOP CHAIN TORP / TOSP



For Sushi Conveyors

Safe Conveyance

Crescent-shaped top plates keep the amount of space between links constant during conveyor curves, minimizing the chance of fingers or conveyed objects getting caught in the gaps.

Scratch-Proof

The top plates are plastic, so scratches and other such damage to conveyed objects are kept to a minimum.

Full-Surface Conveyance

Unlike with conventional top chains, where only carry-way conveyance is possible, the entire top plate surface can be used to convey objects for effective use of the whole conveyor.

Low Conveyor Height

There is no return-way chain, thus avoiding chain slack and sliding against the rollers. The low height of the conveyor enables installation in places where top-to-bottom space is limited.

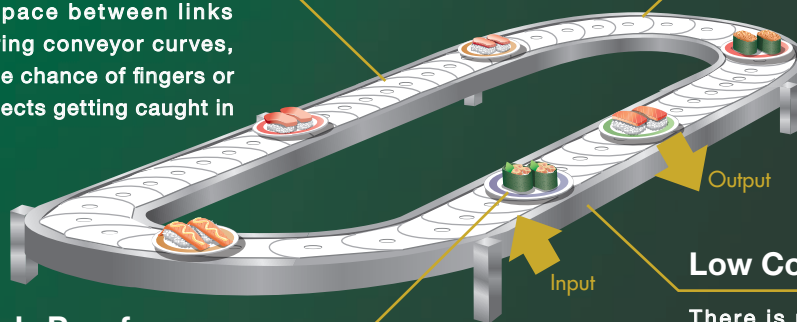

Note: Plastic Top Chain cannot be used in environments where it will be exposed to detergent and other such chemical liquids. Please contact a Tsubaki representative for chemical-resistant Plastic Top Chain.

Plastic Top Chain

Chain (Stainless Steel Pins)

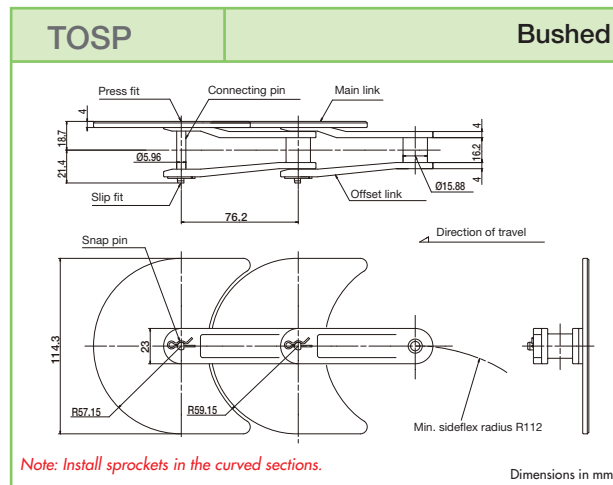
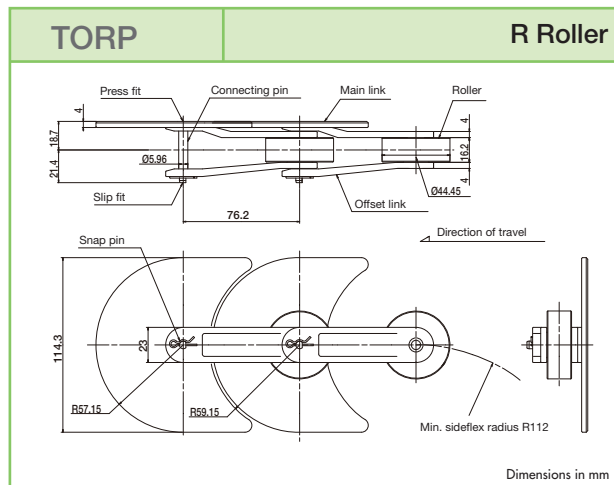

Tsubaki model no.	Max. allowable load kN {kgf}	Operating temperature range °C	Max. allowable speed m/min	Approx. mass kg/m	Top plate main link	Offset link	Roller	Connecting pin/snap pin	Link color
TORP1143	0.69{70}	0 to 60	20 m/min and under	1.40	Reinforced polycarbonate	Reinforced polycarbonate	Polyacetal	Stainless steel	White
TOSP1143				1.36					

Note: 1. Made-to-order product.

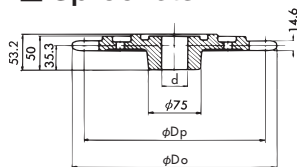

- Shipped chain will consist of a number of standard chain lengths plus (if necessary) one fractional length having the number of links needed to make up the total chain length as ordered by the customer. Standard chain length is 40 links.
- Values for maximum allowable load are at ambient temperature.
- Bearing areas between the pins and bushings are pre-lubricated.
- For TOSP chain, the sprockets should be installed in the curved sections.
- Connecting pins not sold separately.
- Do not use Plastic Top Chain in environments where it will be exposed to detergent and other such chemical liquids. The chain may break due to chemical corrosion. Please contact a Tsubaki representative for chemical-resistant Plastic Top Chain.

Sprockets



Applicable chain	Tsubaki model no.	Actual teeth	Effective teeth	Pitch diameter Dp	Outside diameter Do	Bore diameter d		Approx. mass kg	Material
						Plain bore	Max.		
TOSP	TOS1013T	31	10 1/3	254.59	269	23	45	7.2	FC250
TORP	TOR1100T	11	11	270.47	305			7.6	

Note: Made-to-order product.

For information on conveyor design and handling, safety precautions ⚠️ ⚠️, and warranty not listed in this leaflet, please refer to the Tsubaki Top Chain catalog and Top Chain Engineering Manual.



TSUBAKIMOTO CHAIN CO.

Headquarters

Nakanoshima Mitsui Building
3-3-3 Nakanoshima, Kita-ku
Osaka 530-0005, Japan
Phone : +81-6-6441-0011
URL : <http://tsubakimoto.com/>

Chain & Power Transmission Sales

1-3 Kannabidai, 1-chome
Kyotanabe, Kyoto 610-0360, Japan
Phone : +81-774-64-5022

TSUBAKI YAMAKYU CHAIN CO.

Global Market Development Department

2-15-16 Takanawa, Minato-ku
Tokyo 108-0074, Japan
Phone : +81-3-3445-8518
Facsimile : +81-3-3445-4330

Figures in this leaflet are given in both SI units and gravimetric units (in { }). Figures in { } are for reference.

Note: In accordance with the policy of TSUBAKIMOTO CHAIN CO. to constantly improve its products, the specifications in this leaflet are subject to change without notice. The logos, brand names, or product names in this leaflet are trademarks or registered trademarks of Tsubakimoto Chain Co. in Japan and other countries.
Catalog No. ME1406 ©2014/6 TSUBAKIMOTO CHAIN CO. Printed in Japan ©1,000